



6100 COUPÉ

**CUSTOMISE. PERSONALISE.
IT'S YOUR JOURNEY, MAKE IT A WHITEHAVEN.**

At Whitehaven, we put you and your experience at the heart of the design process. Being a truly bespoke boat builder we offer an exceptional level of customisation. Every Whitehaven is unique, just like their owners, so let us guide you through the journey of creating your ultimate luxury entertainers motor yacht.



WHITEHAVEN

MOTOR YACHTS

your journey. your whitehaven.

WHITEHAVEN 6100 COUPÉ

SPECIFICATIONS*

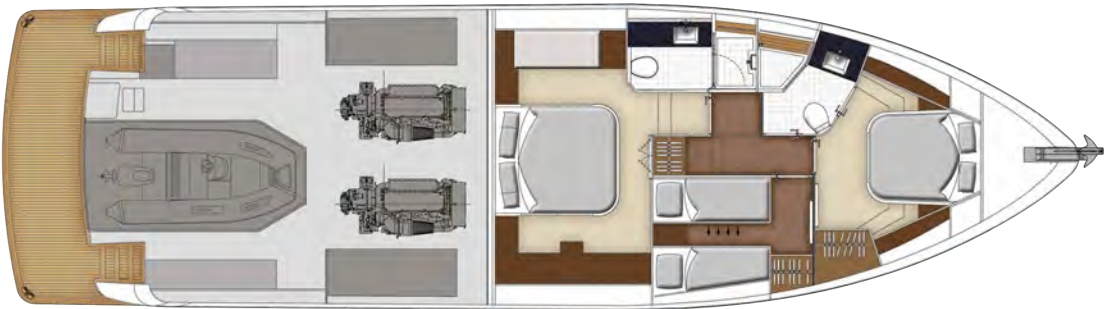

Length Overall (inc, swim platform & pulpit)	19.10m / 62'6"
Beam	5.33m / 17'6"
Maximum Draft	1.52m / 4'10"
Sleeping Capacity	6-8 persons
Fuel Capacity	5,500 litres
Water Capacity	800 litres
Holding Tank Capacity	300 litres
Generator	17.5kW / 50HZ



WHITEHAVEN

MOTOR YACHTS

www.wmy.com.au

Phone 1300 758 896

WHITEHAVEN 6100 COUPÉ

BASE SPECIFICATIONS*

CONSTRUCTION

Deep V moulded GRP hull white gelcoat

Hull top sides core reinforced for light weight

Lightweight moulded GRP roof with windscreen brow extending full length aft to transom

Independent compartments and stringer system

Solid hull bottom with chines to waterline

Vinyl ester resin used in first two outer layers of hull

Water tight collision bulkhead forward

Watertight light weight cored bulkheads/flooring

White hull colour standard/inc boot and pin stripe

MECHANICAL & ELECTRICAL

Acoustic and thermal insulation throughout engine room

4 x 255 amp/hr engine starting 24v maintenance free

4 x 255 amp/hr for domestic 24v power maintenance free

Reverse cycle aircon units cabin master 16,000 BTU

Reverse cycle aircon units fwd VIP 12,000 BTU

Reverse cycle aircon units guest stateroom 3rd cabin 12,000 BTU

Reverse cycle aircon units saloon 48,000 BTU - split units

All AC power outlets RCD protection

All batteries fitted in GRP battery boxes

All hoses double hose clamped

Battery charger 24v 120amp for start bank

Battery charger 24v 120amp for house bank

Battery charger/inverter 24v 5.0kw Victron Quattro

Battery paralleling system for emergency engine start

Bilge pump auto and manual override high water alarms x 3

LED lights for external steps, side deck

Bonding system to hull fittings, zinc anode incl. isolator

Bow and Stern DC electric thrusters 15hp with electronic controls to helm

Bronze struts

Engine mounts anti-vibration

Engine room lighting DC

Electrical panels AC/DC, circuit breakers, volt & amp meters

Fibreglass aqualift for generator with water separator

Stainless steel and fibreglass underwater exhaust system for engines

Fire extinguishing system automatic shut down function

Fresh water heater (20 gallon) AC

Fresh water pressure pump high volume 24v

Stainless steel fresh water tank 800ltrs

Fresh water tap set in engine room

MECHANICAL & ELECTRICAL (CONTINUED)

Fuel filters (dual Racor) for main engine (single for genset)

Fuel lines in copper or USCG all hoses

Fuel tank 5500ltrs with sight gauge & emergency cut off

Hull fittings fitted with ball valve

LED lighting throughout 24v

Manual hand bilge pump

Navigation lights LED international compliant

Non-skid synthetic rubber for flooring in engine room

Oil change system main engines, gearboxes & generator

2 x propellers 5 Blade

Strip lighting under valances in saloon, galley & staterooms

Rudder locking pins

Rudders stainless steel x 2

Seawater pump for foredeck and cockpit

Seawater strainers for engines, genset & aircon

3" shafts stainless steel x 2 with dripless PSS seals

Shore power lead 1 x 32 amp + 15 amp adaptor

Steering - hydraulic power assisted

Tinned electric wiring. Where applicable coded and labelled

Trim tabs with controls at helm

Techma sanitation system with pump out and deck fitting for dock side pump out

High Capacity reversing/docking lights integrated into rear of mast

Ventilation system to include 4 x blowers for engine room

Yacht controller incl. single joystick station

MEZZANINE/COCKPIT

Full length roof that covers the entire cockpit space with super yacht inspired mast

Aft seating with alfresco table

BBQ fitted to cockpit stb side with storage under & exhaust fan

Engine room access hatch lockable

Drawer fridge unit 24V

Flood lights, overhead lighting & courtesy lighting

Hand held shower hot/cold

Stainless framed main saloon entrance 2 door slider

Stainless steel grab rails

Teak laid mezzanine floor

Tender garage under mezzanine/cockpit

Overhead skylights x 4 in dark glass

Wash down taps, fresh and sea water



www.wmy.com.au

Phone 1300 758 896

WHITEHAVEN 6100 COUPÉ

BASE SPECIFICATIONS*

DECK

Anchor SS 45kg (100 lbs) ss, 100mtrs of hi-tensile, 13mm Galv chain
Anchor locker accessed by 2 anchor lock hatches on deck
Anchor chain safety strap
Bow rail welded stainless (316) inc flag staff at bow
Bow rollers stainless self loading for 2 x anchors
Cleats stainless steel x 8, (bow x 2, spring x 4, and stern x 2)
Escape deck hatch from forward cabin
Exterior courtesy deck lights
Fuel fillers on side decks
Fwd windscreen in safety glass bonded to FRP frames
Rub rail with stainless steel insert
Winch 24V vertical, foot switches & remote with chain counter
Non slip on forward & deck sides
Sliding side window tempered glass to helm
Stainless steel swim ladder
Sun pad to forward deck with stainless steel drink holders
Wash down tap (sea water & fresh) in anchor locker
Water tight engine room access door next to tender garage
Windscreen cover to forward saloon screen
S/S bow anchor chain protection plate
Timber flagpole to stern

INTERIOR

Premium vinyl flooring in saloon and companionways, carpet in cabins
Blinds (selected from samples)
Vinyl headliner covered ceiling with wood trim design features
Oak, Teak or Walnut satin finish
LED strip indirect lighting

HELM CONSOLE

Helm chairs adjustable with arm and foot rests x 2
Full width custom made console for instruments
Full engine controls, compass, anchor winch controls
Bow and stern thruster controls
Chain counter, search light remote
Safety monitor panel
VHF radio
Dual chrome plated horn
Windscreen wipers x 2 with washers
Drink holders x 2
Blackwater holding tank indicator

HELM CONSOLE (CONTINUED)

Trim tab indicators and fuel gauges
Lighting overhead courtesy and night light (red)

SALOON

40" LED TV
Reverse cycle air-conditioning 48,000 BTU
Flooring high quality vinyl planking and carpet
Headliner in high quality vinyl
Bose Life Style stereo system with bluetooth
LED lighting overhead
Liquor cabinet, wine fridge & bottle and glass storage
Lounge with timber coffee table
Tinted glass for saloon window
Freestanding dining table with 6 chairs
Glass windshield with 2 piece screens
Electric opening sunroof
Roof skylights x2 in tinted glass with blackout blinds

GALLEY

Convection microwave oven
Cooktop with 4 elements covered with Corian lid
Exhaust fan
Overhead storage lockers
Power points to run from inverter
Single lever mixer tap to galley sink
Solid corian surface benchtops
Storage cabinets & draws below bench
Upright fridge and freezer
Water purifier
Dishwasher drawer
Flooring high quality vinyl

MASTER STATEROOM FULL WIDTH

40" LED Television
Reverse cycle air-conditioning 16,000 BTU
Bedside drawer units
Bureau port side, stool, lift up case with make up mirror
Carpet with underlay
Head board upholstered
King bed, innerspring mattress, drawers and storage
Hanging locker cedar lined incl. auto lighting
Large size viewing port hole incl. 2 opening



www.wmy.com.au

Phone 1300 758 896

WHITEHAVEN 6100 COUPÉ

BASE SPECIFICATIONS*

MASTER STATEROOM FULL WIDTH (CONTINUED)

LED reading lights, courtesy and overhead lighting

Lounge seating stbd side

Private ensuite access

Robe hanging rail, drawers, auto lighting

Full height mirror

MASTER EN-SUITE

Air-conditioning split from State Room

Benchtop solid surface including basin and faucet

Extraction fan

Lighting overhead and vanity

Mirror full width

Shower stall with glass frameless door and teak slat floor

Port hole opening stainless steel

Shower head handheld

Toilet roll holder and accessories

Towel rail x 2

Underbench vanity with drawers and cupboards

Toilet Techma fresh water flush

STATEROOM VIP FORWARD

Access to ensuite/dayhead

Air-conditioning 12,000 BTU with reverse cycle

Carpet with underlay

Hanging locker stbd cedar lined with auto lighting

Hatch (escape) with blind & screen

Head board upholstered

Port hole x 2 stainless opening

Private door entrance

Storage cabinet underneath berth incl. draw units and gas strut for easy access

Queen bed innerspring mattress, drawers and storage

32" TV fitted to wall

GUEST CABIN STARBOARD SIDE

Air-conditioning 12,000 BTU with reverse cycle

Carpet with underlay

Hanging locker cedar lined with auto lighting

Twin single beds in guest cabin including wall reading light

Porthole opening stainless steel

VIP ENSUITE & GUEST HEADS

Air-conditioning split from state room

Benchtop solid surface including basin and faucet

Extraction fan

Lighting overhead and vanity

Vanity cabinet with mirror and shelf storage

Shower stall with glass frameless door & teak slat floor

Port hole opening stainless steel

Toilet roll holder and accessories

Towel rail x 2

Toilet Techma fresh water flush

GENERAL

Antifouling 2 x coats epoxy undercoat and 2 x coats antifoul

Fenders x 4

Docking lines x 4

Combo washer/dryer

Soft furnishing package

BECAUSE WE PROUDLY STAND BY THE QUALITY AND WORKMANSHIP OF OUR VESSELS, EVERY NEW WHITEHAVEN COMES WITH A 5 YEAR STRUCTURAL AND HULL WARRANTY AND 3 YEAR OEM WARRANTY.

Specifications as of 1st August 2019

*This Specification is subject to change without notice



www.wmy.com.au

Phone 1300 758 896

WHITEHAVEN 6100 COUPÉ

BASE SPECIFICATIONS*

WHITEHAVEN 6100 COUPÉ

Volvo Penta D13 1000hp with ZF Gearboxes

ENGINE OPTIONS

Caterpillar C12.9 ACERT 1000hp Twin Disc QuickShift Gearboxes

Caterpillar C18 ACERT 1150hp Twin Disc QuickShift Gearboxes

EURO EDITION

Superyacht interior treatments and exterior upgrades

OTHER OPTIONS

- Chairs x 4 to outdoor table mezzanine
- 2nd Bruce Anchor to be fitted 35kg
- Painted hull topsides metallic
- Hydraulic swim platform/Tender lifter teak laid
- Rear U rails on swim platform
- 4 x rod holder to rear rails
- 2 x Pop-up cleats to swim platform
- Cockpit 32" TV Manual Pop-down
- Karcher pressure cleaner
- Underwater lights x 4 blue or white
- Water Maker with tough hull fitting A/C 130ltr
- LED Transom name board
- Tender (up to 3.6m) with outboard
- Twindisc EJS & EPS systems
- Yacht Controller Remote
- Electronic Package
- Cockpit covers fully enclosed, all weather
- Saloon electric raise / lower windows
- A range of tailored maintenance packages
- Seakeeper SK9 Gyro Stabiliser
- Folding bimini cover to shade forward sunbed
- Guest cabin twin beds convert to double

Layout options to include:

- Alternative master bathroom with ensuite;
- Bunk cabin; or
- Butlers pantry
- Aft Oasis Bar

Specifications as of 1st August 2019

*This Specification is subject to change without notice



www.wmy.com.au

Phone 1300 758 896